

# CTL-8085

## INSTRUCTIVO DE INSTALACIÓN

\*Instructivo solo como referencia de instalación

CTL-8085

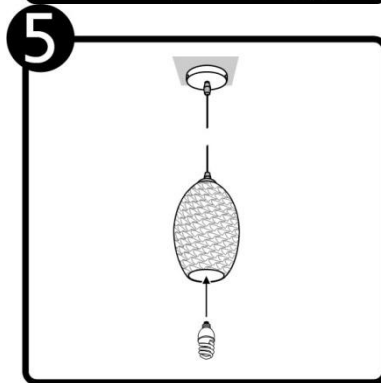
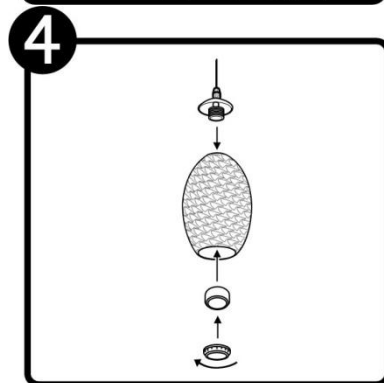
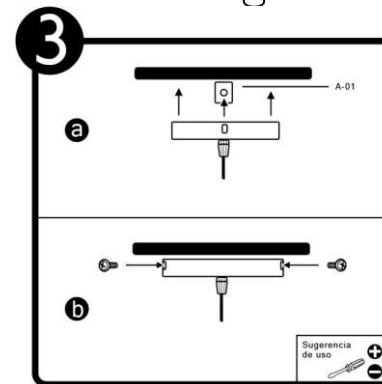
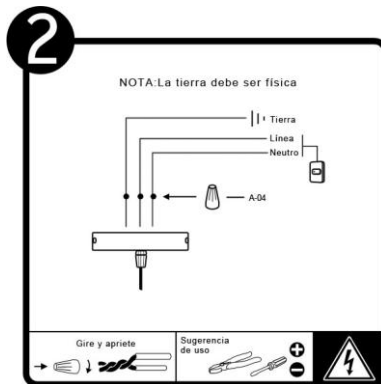
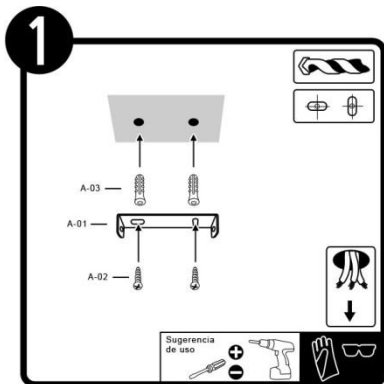

### LISTA DE PARTES:

#### Accesorios Anclaje

- A-01 Anclaje x 1
- A-02 Pija x 2
- A-03 Taque x 2
- A-04 Conector rápido x 3

**RECOMENDACIÓN:** Favor de consultar el instructivo impreso que viene dentro del empaque del producto.